



**RICHFIELD
LUTHERAN
CHURCH**
ELCA
SOUTH MINNEAPOLIS

The R.L.C. Mid-Week News: 07/07/2021

*"Together we will BE the church by living out God's gifts
in the community and the world"*

8 West 60th Street, Minneapolis, MN 55419-2553

Phone: 612.861.2265 Website: www.richfield-lutheran.org

Richfield
Lutheran Church
Online & Phone
Resources

CHURCH OFFICE

PHONE #:

612.861.2265

FAX #:

612.861.2266

WEBSITE & STAFF

E-MAILS:

<https://www.richfield-lutheran.org>

VIDEO WORSHIP

<https://www.youtube.com/channel/UCULV7leJedcPUzrVIP120Mg>

AUDIO WORSHIP

612-474-4974

ONLINE
RESOURCES &
ZOOM LINKS

<https://richfield-lutheran.org/news-events/online-sermons.html>

FACEBOOK/ INSTAGRAM

Richfield Lutheran
Church, Common
Grounds, CELC,
Y-LIFE Youth,
Richfield Lutheran
Theater Company

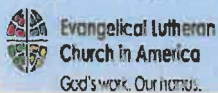

All-Church Meeting

All Church Advisory Meeting In-Person or Zoom: July 11 @ 10:15 a.m.

There will be an all-church meeting after the 9:15 service on July 11th @ 10:15 a.m. to see architect drawings of some of the suggestions from the June 6th feedback meeting. We will not be making any decisions on July 11, but rather view some drawings, sharing in conversation and provide feedback and

suggestions. People are strongly encouraged to attend in person; however, there will also be a ZOOM option for remote attendance. The architectural design concept drawings are included in this newsletter issue for your review and will also be available as a handout on Sunday. Zoom link:

<https://us02web.zoom.us/j/83242391781>

Masks Required When Entering RLC Facility During CELC Hours of Operation

While masks are no longer required for Sunday worship, many of you have noticed the signs that still mandate masks in the hallways and bathrooms. This mandate covers CELC (Creative Early Learning Center) operating hours (Monday-Friday 6 a.m. – 6 p.m).

None of the children in our care are vaccinated, and fully vaccinated adults can still contract and spread the virus, even if an infection stays mild or asymptomatic. All adults entering the building during CELC operating hours are therefore required to wear masks in all public spaces. If you come to the office during the week, you will have to wear a mask when entering the building. Thank you for your compliance.



WELCA Seeks Coffee Hour Hosts

As RLC continues to open back up, the next step will be resuming Coffee Fellowship following The 9:15 worship. WELCA is seeking volunteers for a streamlined hosting option. We are looking for two volunteers per Sunday to initially serve store-bought cookies, coffee and lemonade purchased by WELCA. Stay tuned for more details as they unfold!

Interested in Volunteering as a Coffee Fellowship Host?

Contact Bonnie Nichols or Patty Evans through the church office
@ 612.861.2265 x1





From Pastor Brian Mundt

Post-Exilic Life. In the Old Testament, after Kings David and Solomon, the nation of Israel fell into civil war. Eventually, what's left is conquered by Assyria and Babylon, and the people are exiled to foreign lands. While off in exile, the Israelites remember the "good old days" and dream of how great things will be if and when they do return to the Promised Land. Prophets come and tell them that God will restore them. And eventually, they do return!

But things are not at all how they remember them. It's nothing at all like it was before. Their hopes of returning kept them going. And now they're back, but everything is different.

I think this is like our situation, during the pandemic, and now as we return to our "new normal." Now we knew things would be different. We knew the "new normal" would be different from the "old normal." But only now that we're back is that beginning to sink in. Sure, we expected things to be different, but not this different!

The Israelites responded by rebuilding the Temple, just like it was before. And reinstating all the laws, rules, and practices. Everyone one of them! They responded by getting back to the fundamentals, and doing their darnedest to make everything like it was how they remembered it. No, even more! This set the scene for the Pharisees and the Israel Jesus was born into.

I wonder if they focused on "justice flowing like streams" instead of "crossing every t and dotting every i," if things would have been different. In our time, we talk of "liminal time" and the need to let go of clinging to "the old normal" and lean into "the new normal," as it unfolds. That's hard. We understand it in our heads, but it's hard to do in practice.

God is setting before us life, new life. Let us choose life and grow into it. Yes, that means much of the "old normal" is no longer with us. And that hurts to let it go.

Hebrews 12:1-2 puts it this way: "Therefore, since we are surrounded by so great a cloud of witnesses, let us also lay aside every weight that

clings so closely, and let us run with perseverance the race that is set before us, looking to Jesus the pioneer and perfecter of our faith...."

~Pastor Brian Mundt

bmundt@richfield-lutheran.org



From Mary Beth Weibel

Director of Outreach Ministries

A bit anxious to return to routines in a post-pandemic world?

Welcome to the club! A club that includes millions of people! We have been isolating and doing self-care for so long, it can seem unnatural or give you anxiety to return to a world that involves engagement with others. The professionals at Mayo Clinic cite that you are not alone and their answer is: *Try a bit of volunteering!*

When you are ready to re-engage in the world – think small to make a bigger impact. Here are just a few ideas and needs both within the RLC congregation and surrounding community. Volunteers are needed to:

- be a ride for someone to worship
- be a worker to help serve meals at Loaves & Fishes - Richfield
- be part of a packing team to Feed My Starving Children (stand up or sit down jobs available)
- be a faith education teacher in the coming year at RLC
- be a "rockin' reader" for children or adults in the community
- be a Host Volunteer for Sunday morning coffee or Funeral Ministry service at RLC
- be a transportation volunteer that provides rides for others to the grocery store or pharmacy

These are but a few ways you can re-engage into the world; little by little and step by step. If you are interested in any of these opportunities, or need these services for yourself, a loved one or neighbor, I would love to connect with you so we can dream new and renewed ways to **BE the church in the world**. Stay safe – be kind – and love one another!

Peace, ~Mary Beth Weibel

mbweibel@richfield-lutheran.org



From Meggy Wagner

Director of Business Administration

Our architect Mark Tolvstad of Sjoquist Architects and his team have incorporated many of our ideas from our last meeting into a couple of renditions for our Sanctuary and

Library / Courtyard spaces.

The first two drawings show our Sanctuary with different options for pew placement. Remember, our building consultant pointed out that any space that is less than 50% occupied feels empty and uninviting. She also pointed out that spacing the pews farther apart would increase inclusivity for congregants of all ages, like families with strollers, people with walkers etc. Wheelchair placement was recommended to be neither in the back nor the very front.

The back of the Sanctuary was suggested to be left open for flexible seating, activity tables, or social gathering space. The backwall and the main entrance doors should have as many glass elements as possible, to tie the Sanctuary into the rest of the building. Pews eliminated from the Sanctuary have been placed around the walls of the hallways for non-exclusive seating opportunities during fellowship time.

Our current Sanctuary seats 385 in the pews, with 6 wheelchair spaces. The attached Option A eliminates 11 pews, and spaces the remaining pews 36" apart, while creating 8 wheelchair spaces. This option seats 260 in the pews. Option B equals Option A, but eliminates an additional 4 pews in the back, to allow for open space with flexible use. This option seats 207 in the pews with 6 wheelchair spaces, not counting any overflow in the open back area, or the balcony.

The rendering of the Courtyard and Library incorporates the elevator that would need to be built if we started any major renovation. This location on the North side of the Courtyard was identified in the 2020 Building Study. The drawing also incorporates our wish list for Courtyard use: A prayer walk, nature elements, and a flexible area for outdoor worship, weddings and other events. The Library is shown without any barrier towards the

East Entrance, and a dedicated History Corner with a TV screen to show digitized historic photos, and a sitting area to browse through photo albums.

Our goal for the meeting on July 11 is to fine tune some of these options to get them to a point where we can show them to the Building Department for building code input, and contractors for preliminary pricing estimates. No final decisions will be made until the Fall, when we plan to hold a special congregational meeting to vote on any plans. In the meantime, I am working on a multiyear business plan for CELC, with 2 scenarios, (A: leave childcare as is, B: expand childcare), as a basis for the discussion about the Toddler Wing.

Drawings for our next Building Study meeting, July 11 are attached at the end of this newsletter issue.

~Meggy Wagner

mwagner@richfield-lutheran.org

There are no articles this issue by Mesa Sigrist, Bonnie Nichols, Robbi Moore or Randy O'Brien

HAPPY BIRTHDAY TO YOU!

JULY 02	Marcia Lumbar
07	Allesandra Hinze-Francis
08	Brandi Simpson
08	Gary Strom
10	Marion Baker
11	Barbara Peterson
13	Meggy Wagner
17	Harry Hinze-Francis
18	Paul Curtiss
21	Elisabette Hinze-Francis
23	Claire Aris
25	Evan Decker
29	Ruth Copeland
31	Tony Garcia



May your special day be filled with God's richest blessings!



**The 10:45 Worship
Summer Series
"Scripture & Art"**

Due to meeting schedules, graduations, vaccines and vacations – The 10:45 worship will be meeting once a month in the summer as follows – the 4th Sunday of the month online @ 10:45 a.m.
JULY 25 AUGUST 22



Each month we will check in, sing a little, spend time with scripture and view related artworks. Here is a preview selection. July 25 art is based on

John 6:1-21. Join us via Zoom:
<https://us02web.zoom.us/j/89878480770>

Upcoming
**COMMUNITY
EVENTS**

Looking for something fun to do in July in the Twin Cities – here are some community links featured in our partnership newsletter with TRUST, Inc.



7/10 Dino Stroll Minneapolis Convention Center. Walk among the dinosaurs! Details at <https://www.dinostroll.com/>

7/16-18 Street Machine Nationals – St. Paul The Street Machine Nationals will feature stunning high-performance street machines, hot rods, street trucks and the best dream machines from coast-to-coast, all on display. Ticket information at: <https://www.streetmachinenationals.net/street-machine-summer-nationals-st-paul/>

Tuesdays Bands on the Boulevard at MN History Center in St. Paul. Lawn games start at 5:45. Music starts 6:30ish. Details and band information at: <https://www.mnhs.org/historycenter/activities/calendar>

VIDEO WORSHIP
<https://www.youtube.com/channel/UCULV7ieJedcPUzrVjP120Mg>

WEBSITE RESOURCES & ONLINE BULLETINS
<https://richfield-lutheran.org/news-events/>

AUDIO WORSHIP
612-474-4974
The 10:45 WORSHIP VIA ZOOM
(the 4th Sunday in the Summer)
<https://us02web.zoom.us/j/89878480770>

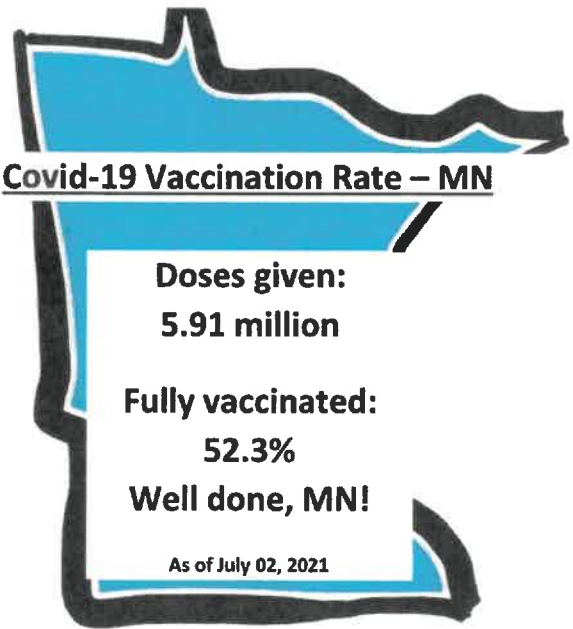

The next issue of RLC Mid-Week News will be published **July 21**. Please submit articles to the church office or to mbweibel@richfield-lutheran.org by **July 15**.



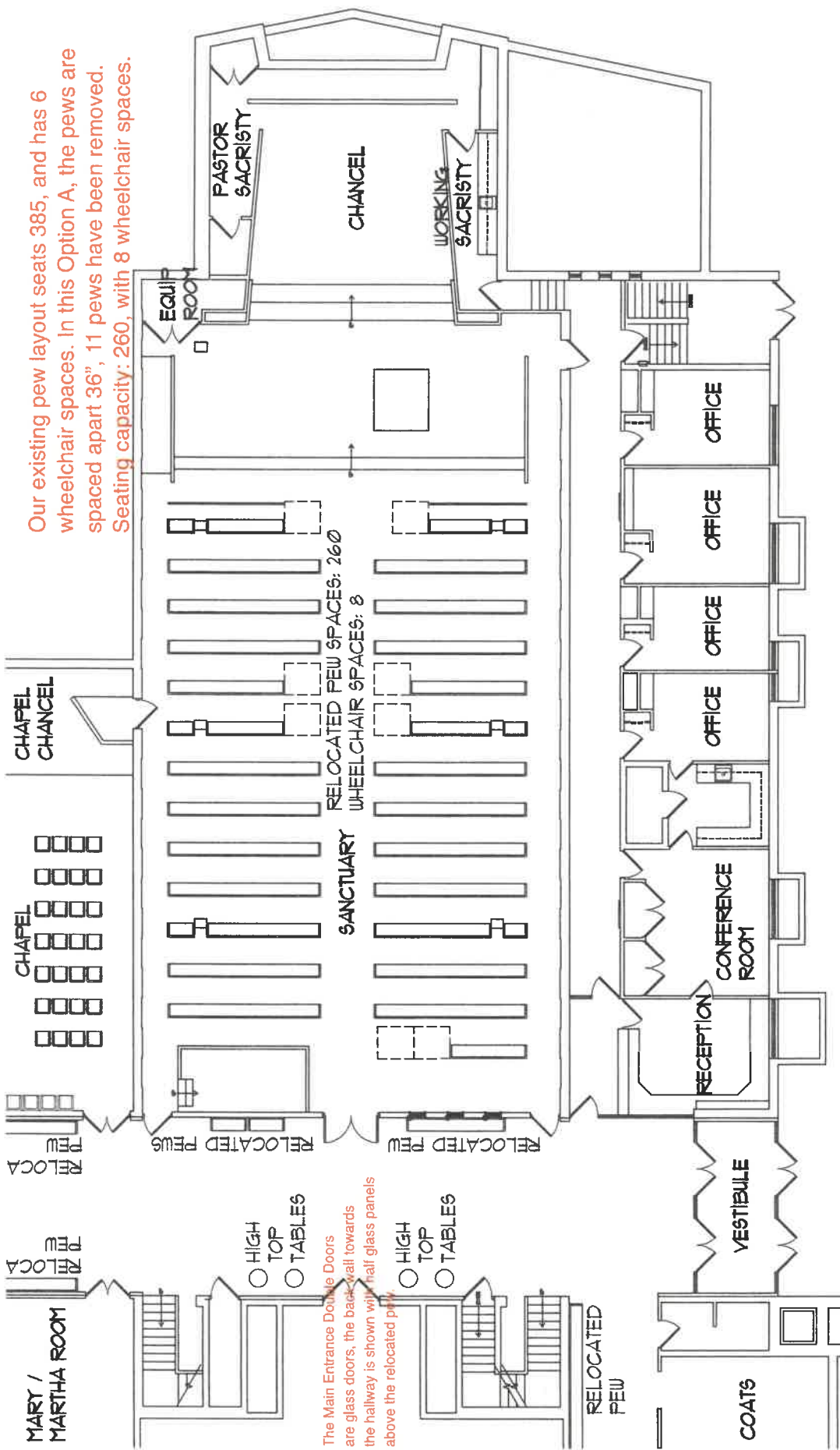

AI ENLARGED SANCTUARY PLAN - OPTION A
 A-101a 1/16" = 1'-0"

Our existing pew layout seats 385, and has 6 wheelchair spaces. In this Option A, the pews are spaced apart 36", 11 pews have been removed. Seating capacity: 260, with 8 wheelchair spaces.

The Main Entrance Double Doors are glass doors, the back-wall towards the hallway is shown with half glass panels above the relocated pews.

- HIGH TOP TABLES
- HIGH TOP TABLES



Sjoquist Architects, Inc
 3020 University Avenue SE # 100
 Minneapolis, Minnesota 55414
 612.379.9233 Fax 612.379.9263



RICHFIELD LUTHERAN CHURCH AND DAYCARE
 MINNEAPOLIS, MN

A-101a

Courtyard and Library

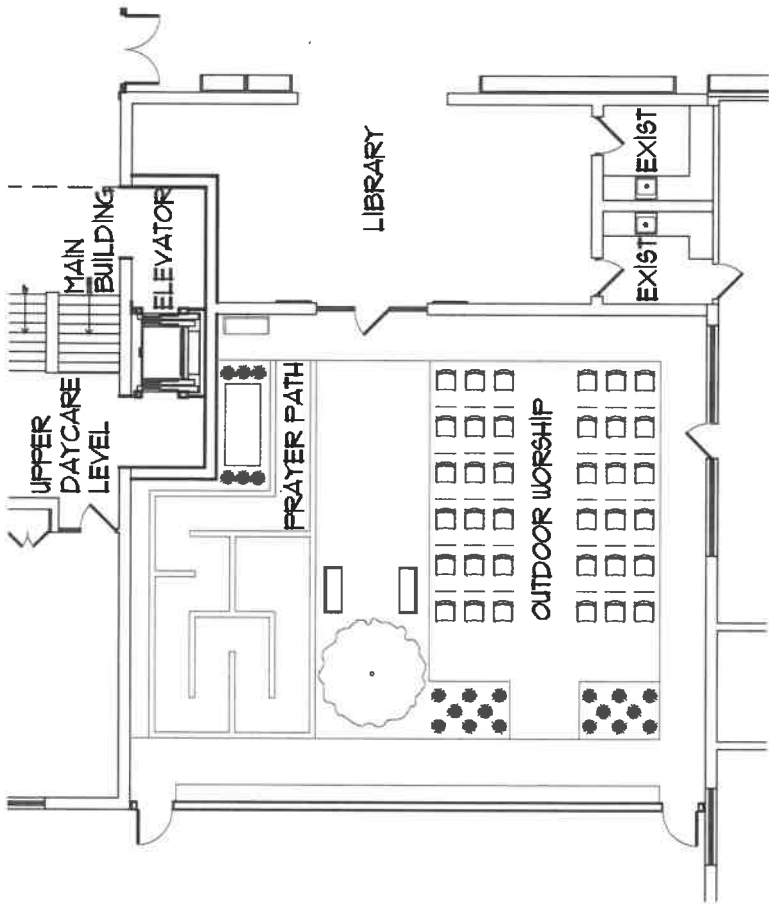

A possible layout for the Courtyard, with the best location for the elevator, as determined in the 2020 Building Study. Several suggestions were made for the use of the Courtyard, and this option tries to incorporate all of them, with a Prayer Path on the North side, some benches and plantings, as well as a flexible area for outdoor worship / weddings / events. Along the fence towards LeJeune Steel is a narrow flower bed for vining plants.

The Library is shown without doors, allowing for an open flow during Fellowship, and connecting the Entrance to the Courtyard.
The North corner and wall space allow for a History Corner, with some tables and chairs to sit down and leaf through photo books, and a wall mounted monitor showing slide shows of digitized confirmation photos, portraits, photos of church activities, etc.

ENLARGED COURTYARD FLOOR PLAN



A1
A-101 1/16" = 1'-0"

	<p>Sjoquist Architects, Inc 3020 University Avenue SE #100 Minneapolis, Minnesota 55414 612.379.9233 Fax 612.379.9263</p>	<p>ISSUED 2021.01.01 E-101 MST CHECKED BY NEW PROJECT DATE</p>	<p>RICHFIELD LUTHERAN CHURCH AND DAYCARE MINNEAPOLIS, MN</p> <p>A-101</p>
--	--	--	---

U.S. PRESIDENTS



Daily Bible Readings

Sunday: Acts 3-5

Monday: Isaiah 40-42

Tuesday: Isaiah 43-45

Wednesday: Isaiah 46-48

Thursday: Isaiah 49-51

Friday: Isaiah 52-54

Saturday: Psalms 73-75

A week ago, we celebrated our independence and the founding of our country. The two puzzles below are about the presidential leaders of our country.

YES or NO? Were the following ever presidents of our country? Yes or No? Circle the correct answer.

Aaron Burr	YES / NO
Andrew Jackson	YES / NO
Millard Fillmore	YES / NO
Harry Truman	YES / NO
Alf Landon	YES / NO
Benjamin Franklin	YES / NO
Thomas Edison	YES / NO
Grover Cleveland	YES / NO
James Tyler	YES / NO
Warren Harding	YES / NO
Daniel Webster	YES / NO
James Garfield	YES / NO
William McKinley	YES / NO
Henry Clay	YES / NO
Bob Dole	YES / NO
Franklin Pierce	YES / NO

Presidents by Last Name

The United States has had 46 presidents.

5 presidents have a last name beginning with T. Can you name them?

5 presidents have a last name beginning with H. Can you name them?

4 presidents have a last name beginning with J. Can you name them?

4 presidents have a last name beginning with C. Can you name them?

Answers below

ANSWERS TO LAST WEEK'S CROSSWORD:

Across — 2. loyal; 8. stripes; 10. flag; 11. colonies; 13. citizenship; 16. celebration; 19. picnic; 23. constitution; 24. British; 27. Congress; 28. bell; 29. anniversary. **Down**—1. bands; 3. freedom; 4. union; 5. cannons; 6. Jefferson; 7. government; 9. patriotic; 12. Philadelphia; 14. democracy; 15. declaration; 17. independence; 18. England; 20. fireworks; 21. birthday; 22. stars; 25. states; 26. July.

BACKWARDS GEOGRAPHY

Think of the last place you visited on a holiday — a city, state or country. This visit might have happened last week or last year or several years ago. Doesn't matter. Then, think of any place in the world that begins with the last letter of your starter location. For example, if you said RENO, then your next location would start with an O. Perhaps OLYMPIA, and so your next place would start with an A, and so on. Do this until you have ten (10) places in the world to complete this backwards geography ladder. **WRITE YOUR ANSWERS HERE:**

ANSWERS TO YES / NO: Aaron Burr, Alf Landon, Benjamin Franklin, Thomas Edison, Daniel Webster, Henry Clay and Bob Dole were NOT presidents. **ANSWERS TO PRESIDENTS BY LAST NAME:** The letter T (5), Taft, Taylor, Trump, Truman, Tyler; The letter H (5), Harding, Benjamin Harrison, William Henry Harrison, Hayes, Hoover; The letter J (4), Jackson, Jefferson, Andrew Johnson, Lyndon Baines Johnson; The letter C (4), Carter, Cleveland, Clinton, Coolidge.